



HODGES
MANAGEMENT AND
LEASING COMPANY

For Lease
25,980 sf

200 Great Southwest Pkwy

Atlanta Gateway



**200 Great Southwest
Parkway**

Atlanta, GA 30336

Owned By:
ING 
REAL ESTATE

200 Great Southwest Pkwy

25,980 Square Feet Available

Available Space:	25,980 sf	Sprinkler:	Yes
Total Building:	25,980 sf	Roof:	Single Ply
Office:	3,772 sf	Stacking Height:	19'
Bay Size:	48'8 x 50'	Doors:	2 (10 x 12) DH; 2 Rail 1 (12 x 12) Drive In

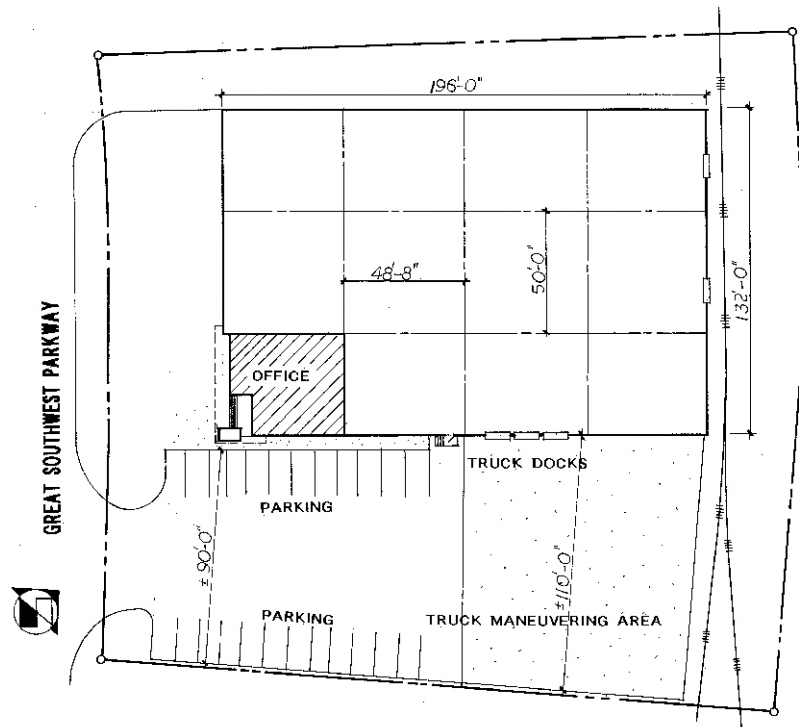

For Leasing Information, Contact:

Bruce Logue

Bruce.logue@hodgesml.com 404.691.4007

3350 Riverwood Pkwy, Suite 850, Atlanta, GA 30339