



HODGES
MANAGEMENT AND
LEASING COMPANY

For Lease
63,472 sf



Atlanta Gateway

250 Great Southwest Pkwy



**250 Great Southwest
Parkway**

Atlanta, GA 30336

Owned By:
ING 
REAL ESTATE

250 Great Southwest Pkwy

63,472 Square Feet Available

Available Space:	63,472 sf	Sprinkler:	Yes
Total Building:	63,472 sf	Building Depth:	162'
Office:	3,161 sf	Stacking Height:	21'
Bay Size:	40' x 48'	Doors:	8 (10 x 12) DH; 8 Rail

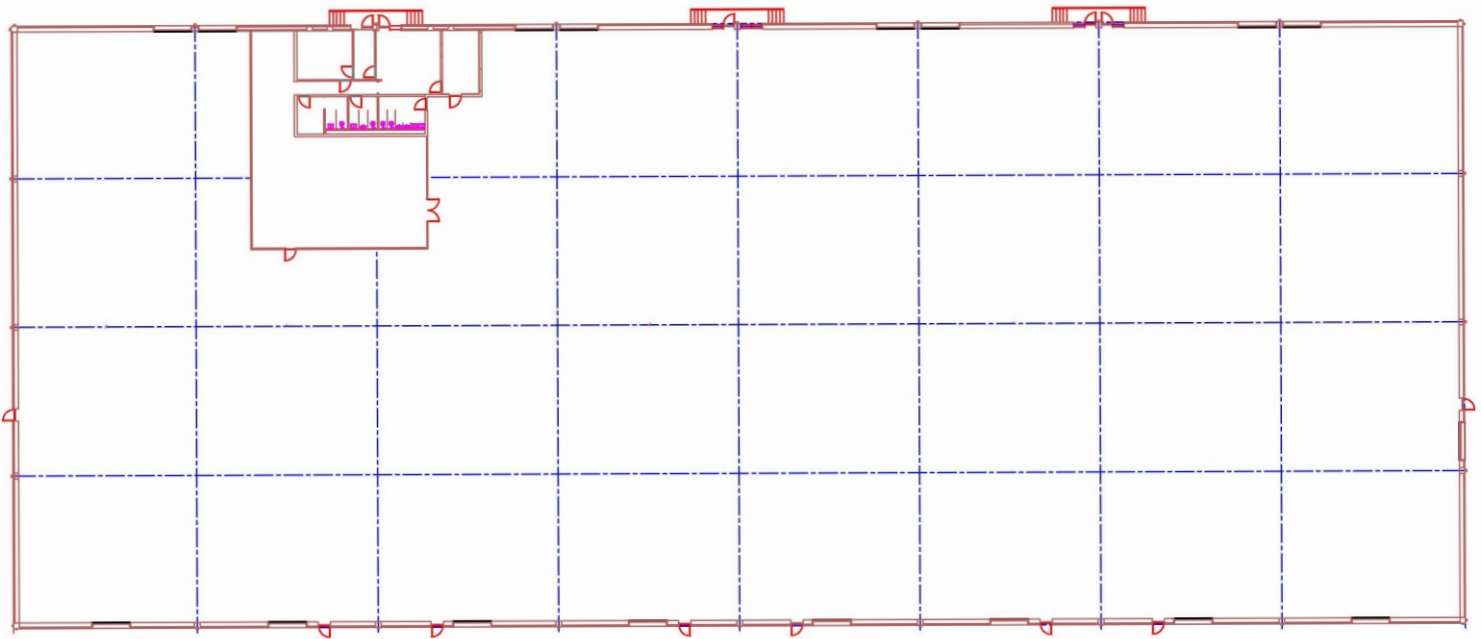

For Leasing Information, Contact:

Bruce Logue

Bruce.logue@hodgesml.com 404.691.4007

3350 Riverwood Pkwy, Suite 850, Atlanta, GA 30339