



HODGES
MANAGEMENT AND
LEASING COMPANY

For Lease
100,985 sf

4875 Westpark Drive

Westpark



4875 Westpark Drive
Atlanta, GA 30336

ING 
REAL ESTATE

4875 Westpark Drive

100,985 Square Feet Available

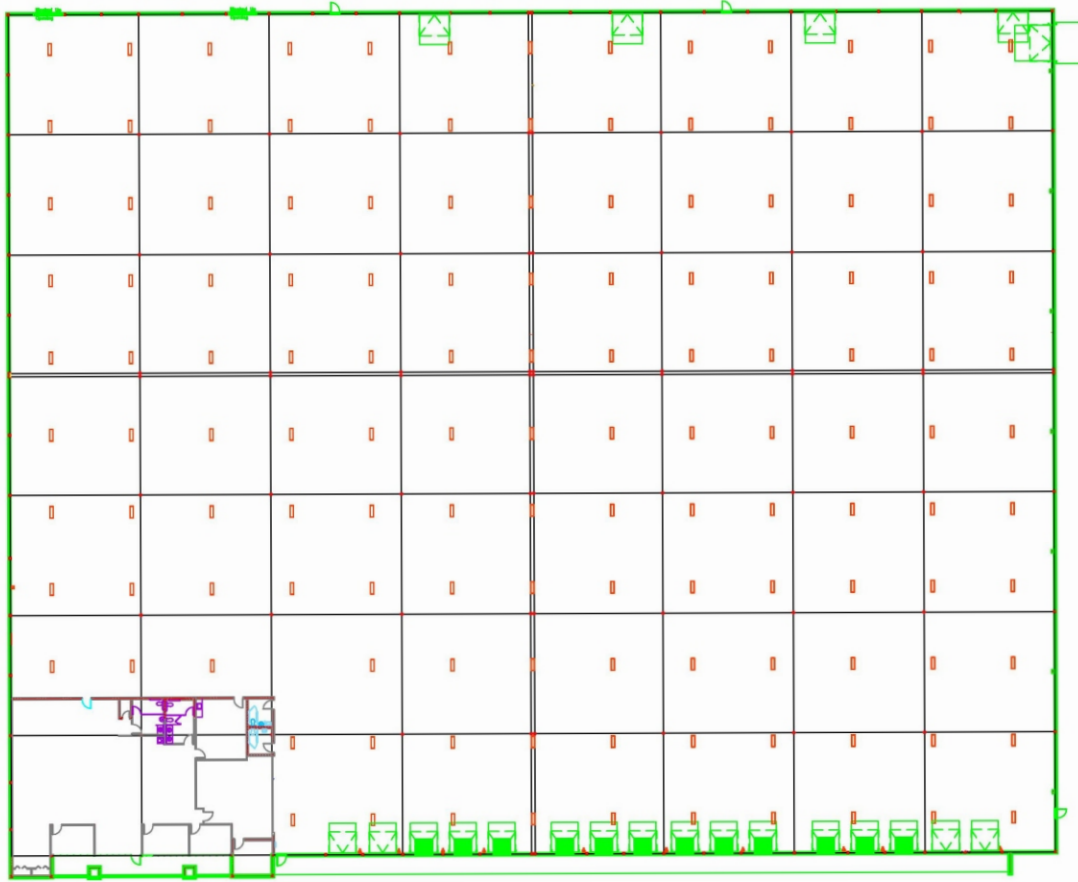

Available Space:	100,985 sf	Sprinkler:	Yes
Total Building:	100,985 sf	Stacking Height:	24'
Office:	5,000 sf	Doors:	14 (8 x 10) DH with 12 Levelers
Bay Size:	40'6 x 44'		

For Leasing Information, Contact:

Bruce Logue

Bruce.logue@hodgesml.com 404.691.4007

3350 Riverwood Pkwy, Suite 850, Atlanta, GA 30339