



**HODGES**  
MANAGEMENT AND  
LEASING COMPANY

**For Lease**  
**29,721 sf**

**5605 Gwaltney Drive**  
**Westpark**



**Suite B**

5605-B Gwaltney Drive  
Atlanta, GA 30336

**ING**   
REAL ESTATE

# 5605-B Gwaltney Drive

## 29,721 Square Feet Available

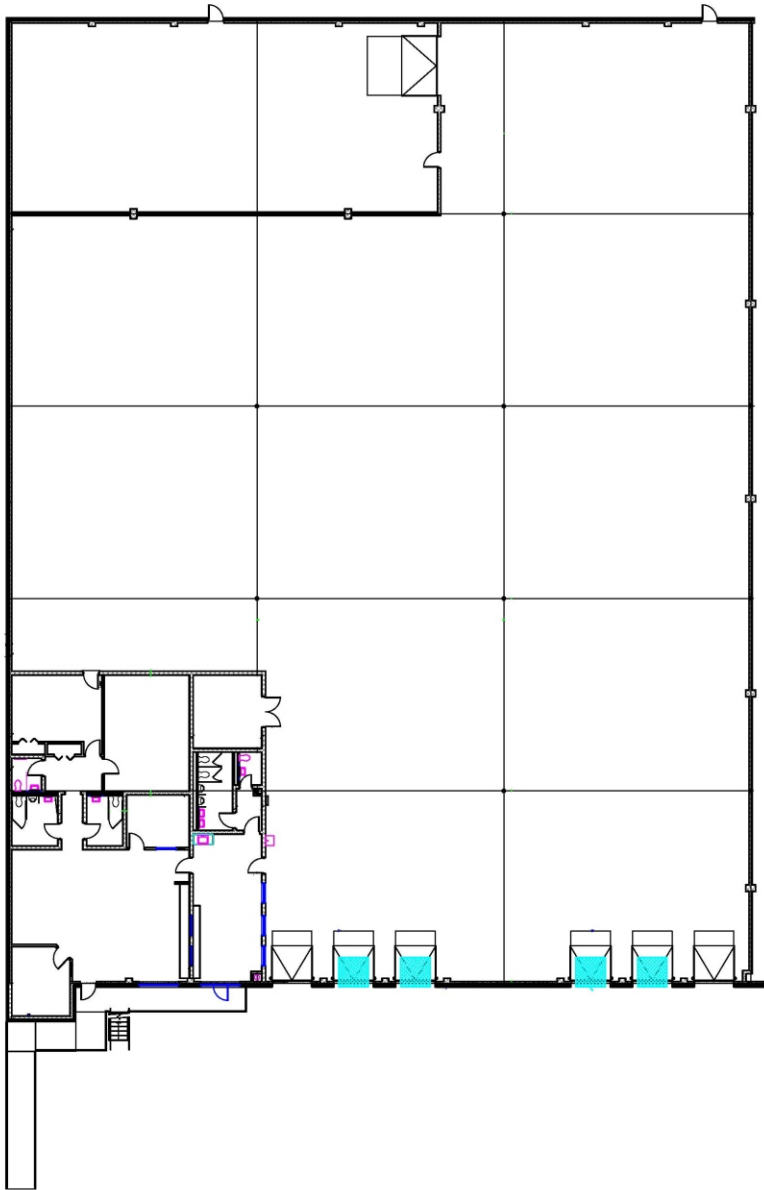

Available Space:	29,721 sf
Total Building:	59,441 sf
Office:	1,475 sf
Bay Size:	50' x 39'
Sprinkler:	Yes
Stacking Height:	22'11
Doors:	6 (8 x 10) DH

**For Leasing Information, Contact:**  
**Bruce Logue**

**Bruce.logue@hodesml.com    404.691.4007**

3350 Riverwood Pkwy, Suite 850, Atlanta, GA 30339