

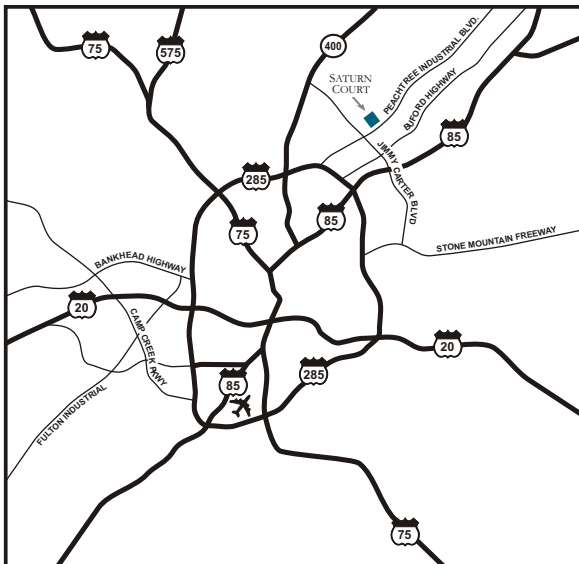

HODGES
MANAGEMENT AND
LEASING COMPANY

For Lease
10,100 sf

5425 Peachtree Industrial Blvd.
Saturn Court



Suite E

**5425 Peachtree Industrial
Boulevard**

Norcross, GA 30092

5425 Peachtree Industrial Blvd. 10,100 Square Feet Available

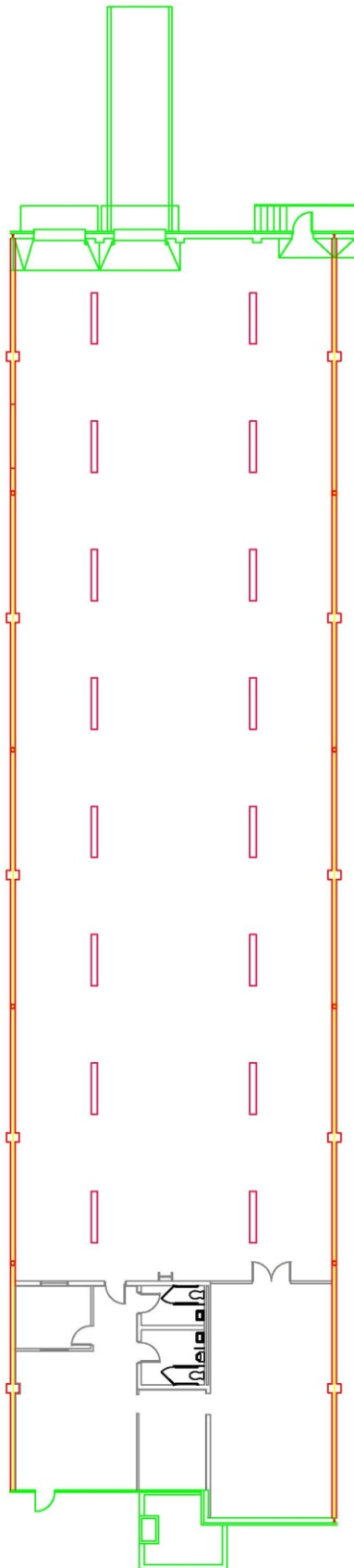

Available Space:	10,100 sf
Total Building:	81,102 sf
Bay Size:	40' x 50'
Doors:	2 (8 x 10) DH; 1 DI
Sprinkler:	Yes
Stacking Height:	22'
Office:	2,320
Building Depth:	201'

For Leasing Information, Contact:

Chet Koenig

404.691.4007

chet.koenig@hodesml.com

3350 Riverwood Pkwy, Suite 850

Atlanta, GA 30339