



HODGES
MANAGEMENT AND
LEASING COMPANY

For Lease
50,817 sf

6386 Corley Rd
Peachtree Corners



6386 Corley Rd.
Norcross, GA 30092

Owned By:
ING
REAL ESTATE

6386 Corley Road

50,817 Square Feet Available

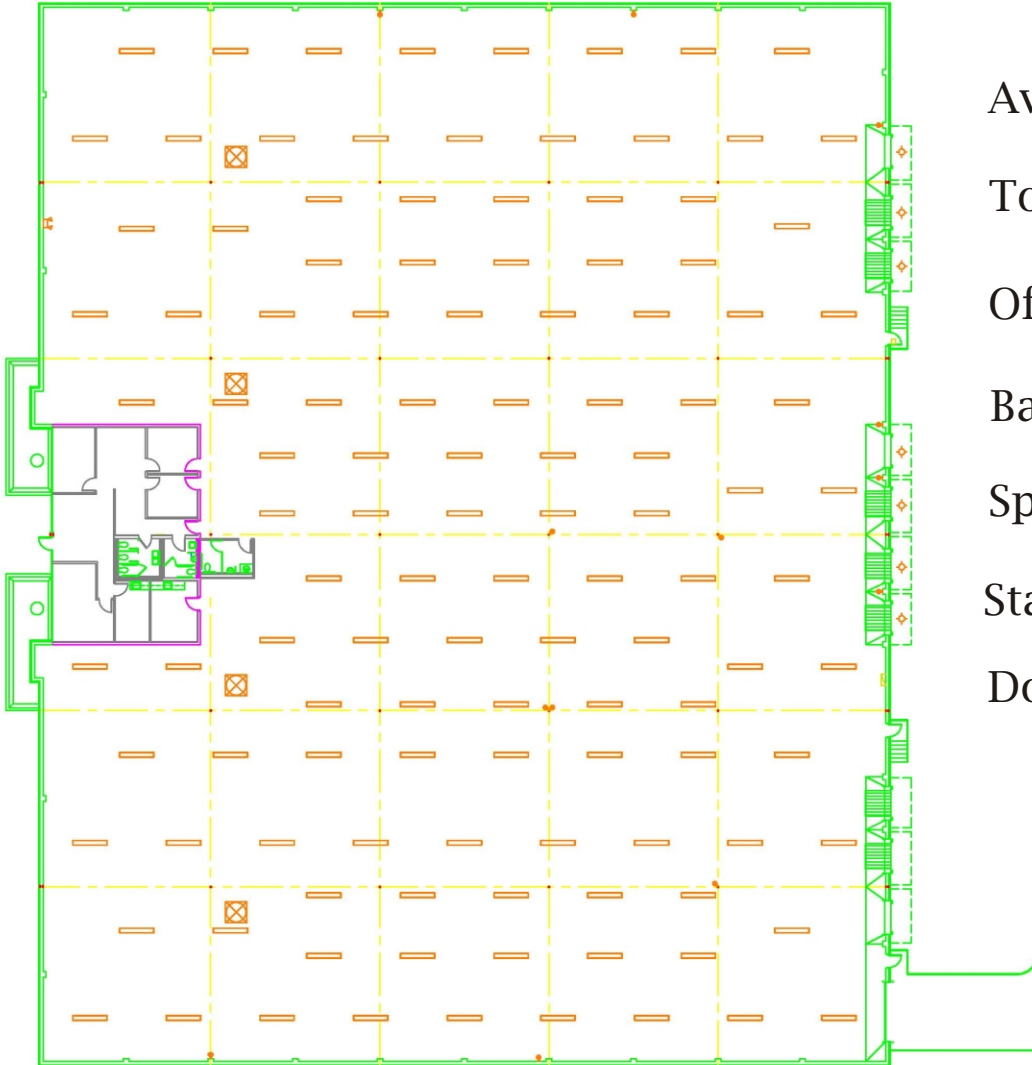

Available Space: 50,817 sf

Total Building: 50,817 sf

Office: 1,843 sf

Bay Size: 40' x 41'8

Sprinkler: Yes

Stacking Height: 22'

Doors: 10 (8 x 10) DH;
1 (14 x 16) DI

For Leasing Information, Contact:

Chet Koenig

404.691.4007

chet.koenig@hodgesml.com

3350 Riverwood Pkwy, Suite 850

Atlanta, GA 30339